



Nottinghamshire Lincolnshire & Derbyshire

Rugby Football Union

NLD U13s Finals Day

Sunday 4th May 2025

Sleaford RFC

Under 16s: Free

16+: £3



A very warm welcome to Sleaford RFC for our U13s Finals Day. My thanks to the club for hosting us today and their volunteers for making this possible at the end of a long season.

Many congratulations to all of the clubs that have reached the finals, including those who are playing at different grounds today, and I hope you have a great day and a competitive match. It is inevitable that, in a final, one side will be disappointed with the outcome but if you play collectively the best you can and give it your all individually on the pitch, you can do no more and be proud of your achievement in getting to the final. My thanks go to the coaches, first aiders, other volunteers and not least parents who have made this season-long journey to the final possible.

The organisation of our competitions throughout the season is down to the hard work of our Junior Competitions Committee so my sincere thanks to them too. Within NLD RFU, we always welcome a helping hand from people who have the time, however little that may be, so if you feel you can help us in some way, please let us know.

Finally, my thanks to the match officials without whom we would not be able to play our game. Respect is a cornerstone of our values and I respectfully ask that this is upheld at our matches today.

Have an enjoyable day.

Bob Curry

NLD Honorary President 2024-2025



U13's NLD Finals Day 2024/25 Season

Hosted by Sleaford RUFC @ David Williams Pavillion

Sleaford, NG34 8SP

PLEASE NOTE THERE IS AN NLD ADMISSION CHARGE OF £3 PER ADULT
AT THIS EVENT WHICH IS PAYABLE AT THE GATES IN CASH ONLY

Timings are crucial to the success of the day, please could all teams stick to the timings provided. Please could team managers ensure that all belongings are removed from the changing rooms at the end of your allotted slot and after the match and showers that the changing rooms are swept clean for the next team.

NEITHER NLD OR SLEAFORD RUFC WILL ACCEPT ANY LIABILITY FOR
LOST, STOLEN OR DAMAGED PROPERTY OR BELONGINGS AT THIS
EVENT

Fixture Schedule

10.00am	U13s Plate Final Melbourne v Southwell	Pitch 2
10.15am	U13s Vase Final Stamford v Scunthorpe	Pitch 1
12.00 noon	U13s Bowl Final Mellish v Newark	Pitch 3
12.15pm	U13s Shield Final Lincoln v Ashbourne	Pitch 2
2.00pm	U13s Cup Final Derby v West Bridgford	Pitch 1

Sleaford Rugby Club Plan



Parking

Car Park 1 – Cars Only

NLD Officials & Referees

Car Park 2 – Cars Only

All wave fixtures to park on this area.

Disabled Parking

Please present your disabled parking pass to the parking attendants, and they will assign you a designated space.

Coaches

Coaches are kindly requested to park at the players' entrance of the club, which is the side of the club as indicated on the map above.

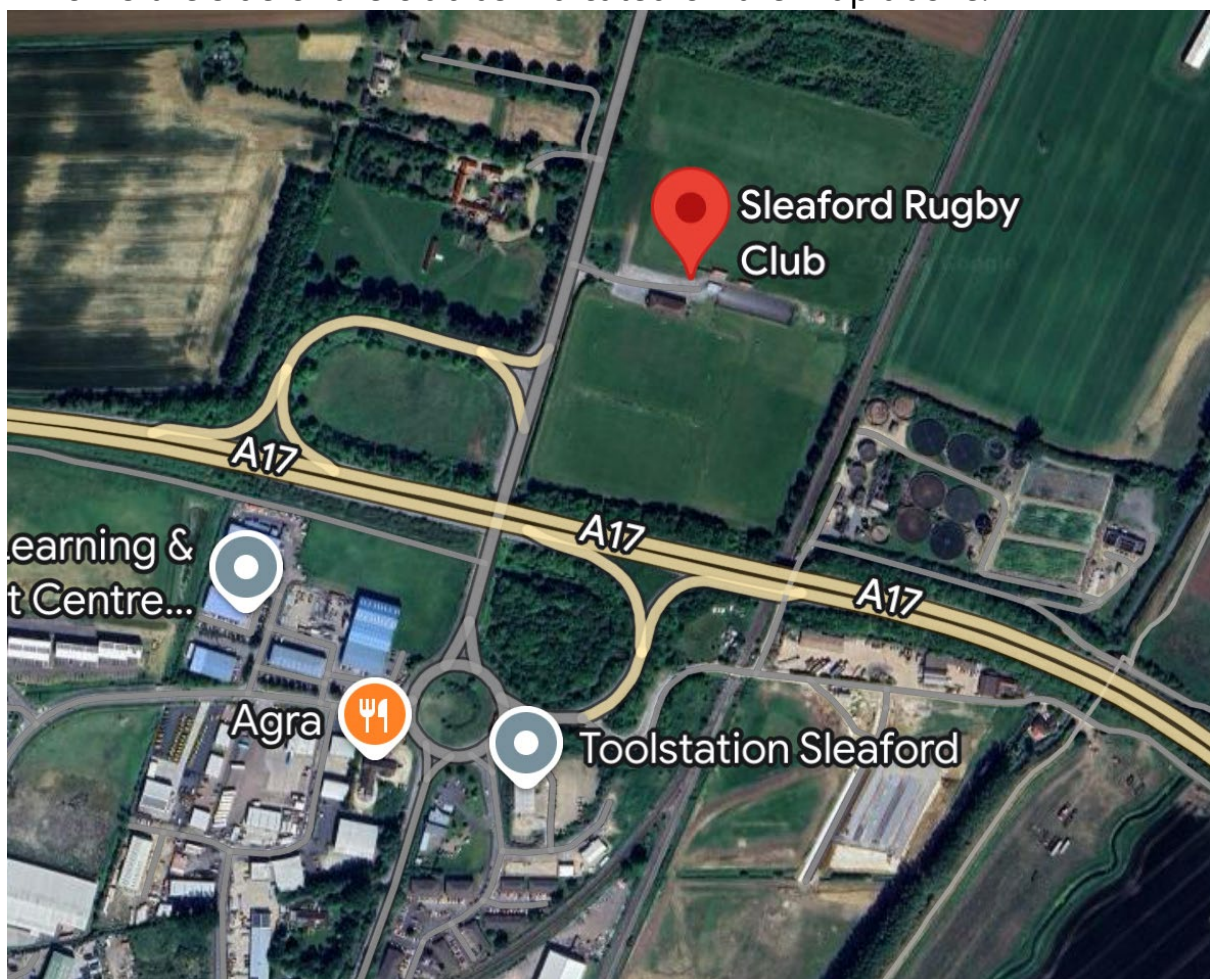

Changing Room Layout

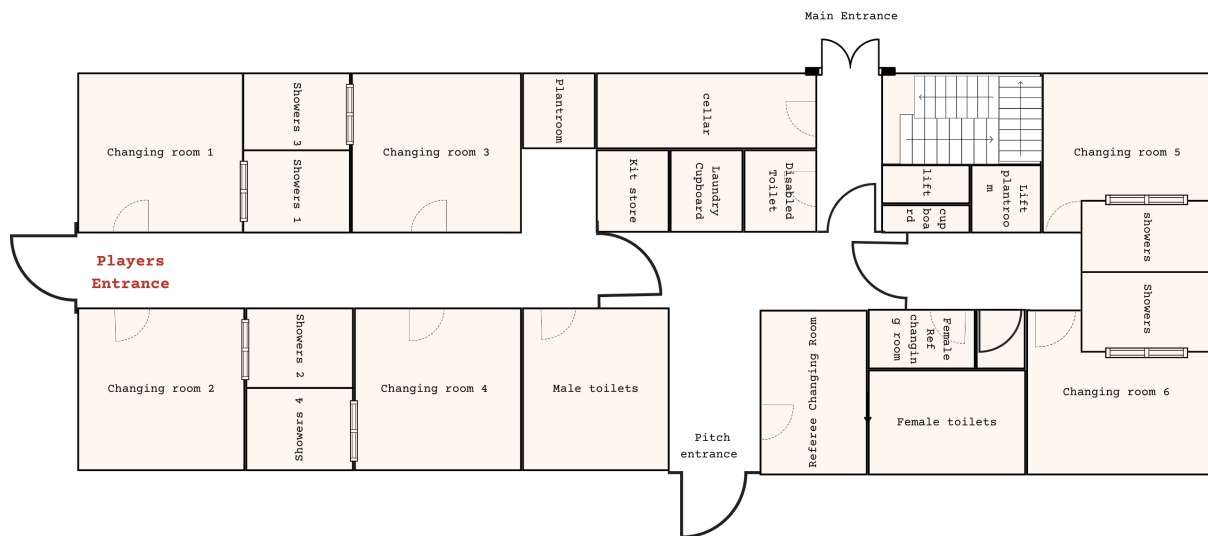

Meals & Catering

Players Meals – FOC served in the clubhouse suite as per allocated time slot

- Referees and NLD Officials – Buffet served from 11am in the Crawford Suite
- Spectators – Snacks and drinks available to purchase from the clubhouse bar, BBQ downstairs as well as an Ice Cream van on site.

Photography

There will be a photographer attending the finals day. Craig Symonds from Box Photography is a regular at NLD finals each year. He will take photos and print/sell them on the day which is great for parents & players to be able to get a memento on the day.

Please inform us of any players which are safeguarded and should be excluded from any photography

Emergency Contacts

Club Official – Mike Jones 07464 443394

First Aid Lead – Skye Milne 07375 952472

One final message!

A GOOD SPECTATOR WILL;

- Respect the decisions made by the coaches and referees
- Offer encouragement, not criticism
- Remember that players are here to have fun and develop, not to have their self-esteem diminished
- Act as a role model, and encourage fair play, teamwork and sportsmanship

A BAD SPECTATOR WILL;

- Argue decisions made by the referee and coaches
- Disrespect the opposition
- Shout at players, which could be considered as bullying or harassment
- Have a 'win at all costs' attitude and be angry if the team lose



TEAMWORK RESPECT ENJOYMENT DISCIPLINE SPORTSMANSHIP



Website: www.nldrfu.co.uk

Facebook: <https://www.facebook.com/nldrfu/>

Instagram: <https://www.instagram.com/nld.rfu/?hl=en>

Email: Junior.competition@nldrfu.co.uk

Thank you to our sponsors for their continued support



COACH PARKING

**Good luck to all the teams and we hope everyone
has a great day!**